

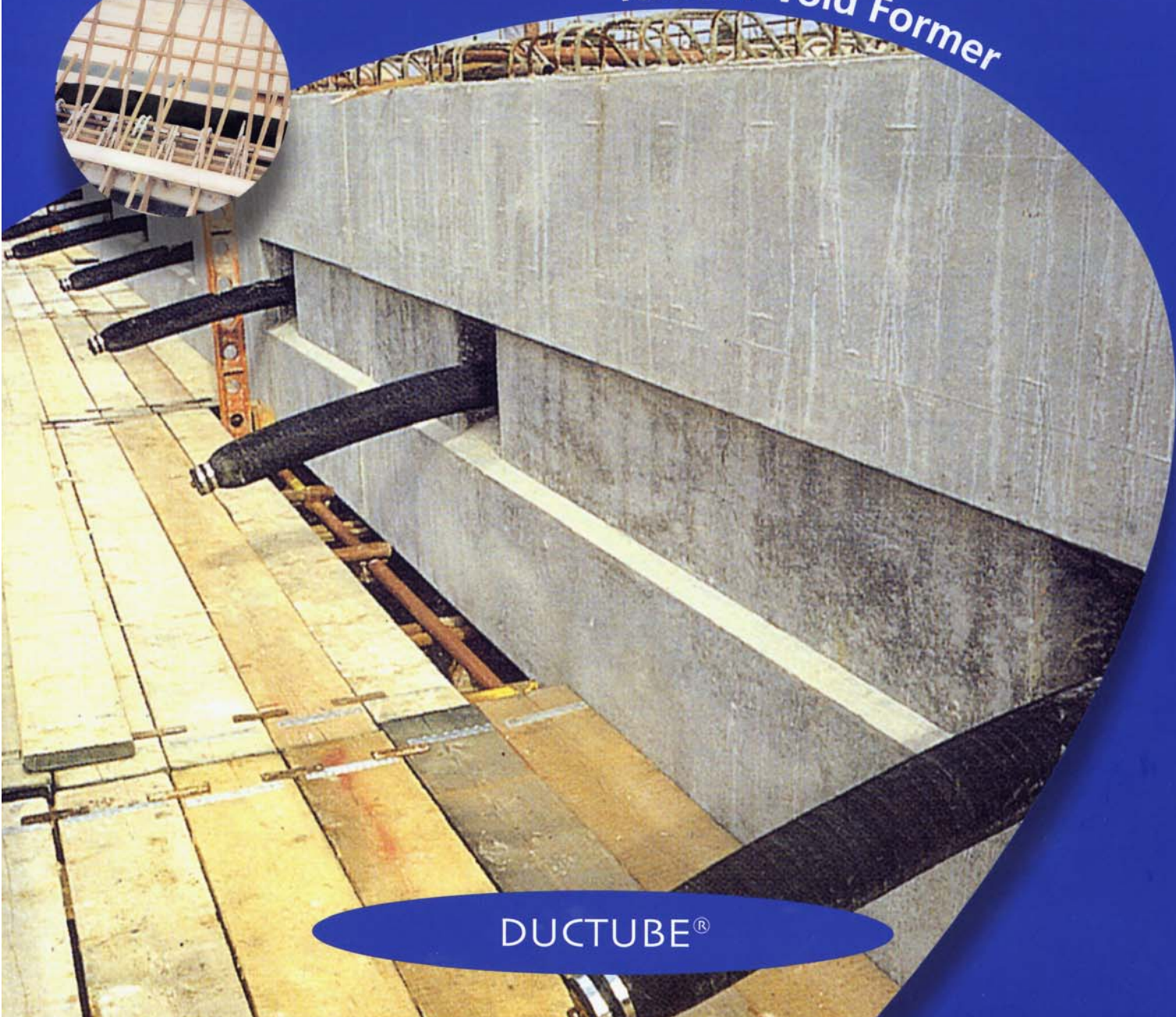

Tubular Void Former



DUCTUBE®



An outer protective cover is applied as a sheet in a manner similar to that of the inner lining. The whole is then very tightly wrapped in a spiral fashion, using a very closely woven synthetic textile tape. This process eliminates air and tightly consolidates the structure.

Finally, the process known as 'vulcanisation' is carried out at a high temperature and pressure, resulting in total homogenisation of the rubber layers and chemical stabilisation of the whole structure.

After 'vulcanisation', the spiral wrapping cloths are removed (leaving the recognisable fabric braiding impression on the outer finish), and the tube is removed from the former mandrel.

The combination of rubber and braiding enables the tube to be consistently inflated and deflated over numerous applications.

Ductube can be supplied with end fittings comprising of a plug incorporating a Schrader valve (similar to that of a tyre) at one end of the tube and a blank plug at the other. Both fittings are securely held in place by externally applied stainless steel straps. During inflation the design allows a two-way movement by an increase in the diameter and reduction in the overall length. The reverse situation occurs when deflating Ductube, ensuring an automatic detachment from the concrete without the need for release agents.

Ductube is one of nine key products supplied by BRC Special Products.

Formed in January 2003 when BRC Building Products of Stafford and BRC Special Products of Warrington were brought together, BRC Special Products is a new strategic division that supplies specialist products to the construction and building industry.

Our range of products spans various construction areas including Groundworks, Structures and Masonry/Walls.

Ductube is part of our Structures range of products.

What is Ductube?

Ductube is a high quality re-usable pneumatic rubber tube void former with a unique braided core.

Once inflated and fixed in position, Ductube is cast in concrete which, when cured, allows the tube to be deflated. This leaves a uniform tubular void which can be used for a multitude of applications.

From manufacture to use

Ductube is made from a natural rubber-based compound which is lapped tightly around a mandrel (steel former).

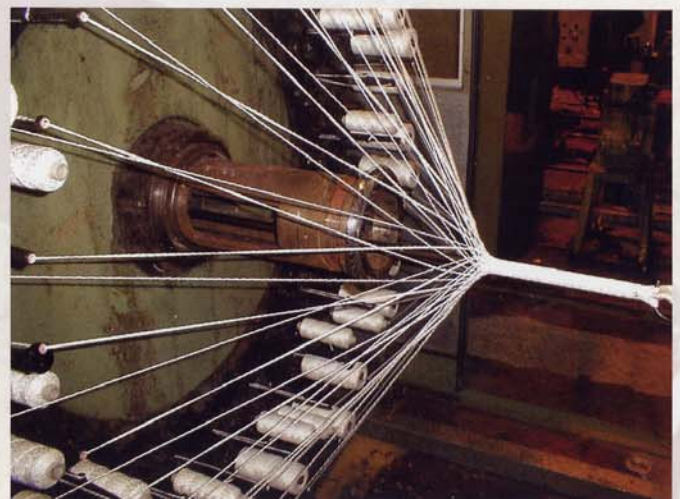

What benefits can Ductube offer?

Re-Use Value

Provided reasonable care is taken in handling and storage, Ductube can be used between an expected 25 and 50 times depending upon application. Ductube should never be stored in direct contact with UV rays as this breaks down the rubber content of the tube and accelerates fatigue.

Simplicity

Ductube is supplied in lengths to meet customer requirements. Simply place, fix, inflate to size and pour concrete (max length 17 metres).

Safety

All assembled tubes are fully tested prior to despatch ensuring high quality standards are maintained. Each tube is designed with a safety factor of 3. This, coupled with relatively low operating pressures, ensures safe usage.

Flexibility

Ductube has endless applications for the construction industry, both on site and in precasting applications. Whilst the tube has a high circumferential strength, it is equally flexible in length, enabling radius as well as straight voids to be formed.

Applications

Ductube has been used successfully in countless applications, a number of which are shown opposite. We are pleased to offer technical support and to discuss specific applications with customers.

Examples

- Precast void products
- Multiway cable ducts
- Post tensioning ducts
- Pre stressing ducts
- Steel sheathing support
- Air gap shutters
- Shaft lining
- Hollow pile cores
- Stormwater culverts
- In-situ slotted drains
- Porous drains
- Chimney and flue lining

Since its introduction in the early 1960s, Ductube has been used to line thousands of chimneys. It acts as the former to create a new flue in combination with a lightweight thermal concrete mix.

This process is used for both old chimneys and those that are newly built. The benefits of using Ductube are that it makes the flue suitable for all types of fuel, it insulates the flue, reinforces the brickwork internally and improves the general flue characteristics.

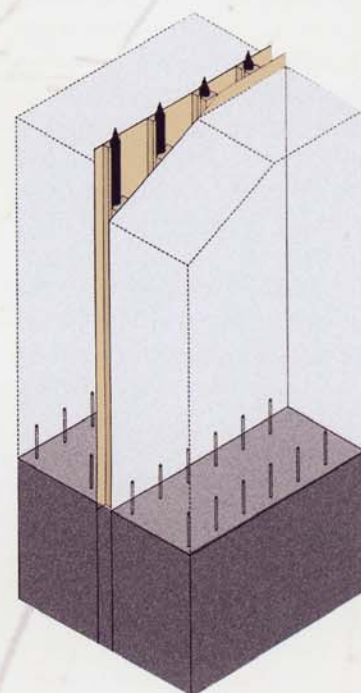

Placing your order

When calculating the uninflated length to order, please allow for:

- 1) reduction in length due to inflation
- 2) end pieces (length 'B' in mm from table opposite) x2
- 3) working tolerances for installation and removal.

When placing the order please state both the 'inflated and deflated' size required, together with the deflated length.

Please check availability before ordering due to the natural curing time of this product from manufacture through to despatch.

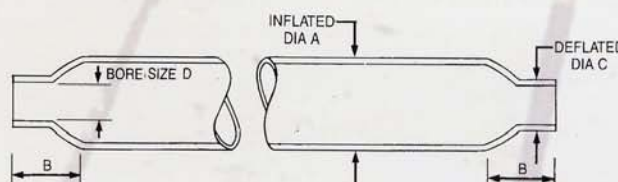

Inflated Dia A mm	B mm	Deflated Dia C mm	Bore Size D mm	Weight kg/mtr	% Reduction in Length	Nominal Air Pressure lbs/ins	Minimum Radlii mm
Standard Weight							
19	60	15	6	0.20	5.5	95	76
25	75	20	8	0.34	5.5	90	100
38	150	24	11	0.43	8.8	85	152
44	100	29	13	0.58	5.3	90	176
52	130	32	16	0.62	10.4	75	208
63	200	40	25	0.90	6.6	55	252
76	150	52	38	1.15	5.6	35	304
90	150	65	51	1.60	7.2	30	360
Lightweight Dual Size							
100	200	76	57/63	2.10	7.0	28	400
110					9.0	38	
100	150	90	76	2.00	8.0	18	500
127					12.9	28	
127	250	102	90	2.20	7.0	18	889
152	200				15.7	32	
152	250	115	102	2.75	8.7	18	1216
178	200				17.0	32	
178	200	140	127	3.70	7.6	12	1424
203	250				13.0	18	
203	250	166	152	4.20	6.3	10	2030
229	300				10.7	14	
229	250	178	165	4.40	5.8	10	2750
254	300				10.0	14	
254	300	216	203	4.80	11.3	12	3050
280	350				18.9	28	
280	200	242	229	5.50	12.5	14	3360
305	250				17.3	20	
305	250	242	229	5.50	17.3	20	3660
330	300				21.4	40	
330	400	267	254	5.90	12.7	10	3960
356	610				18.7	20	

BRC

SPECIAL PRODUCTS

For more information on Ductube please contact:

BRC Special Products
Carver Road
Astonfields Industrial Estate
Stafford
ST16 3BP, England
Tel: 01785 222288
Email: stafford.enquiries@brc-special-products.co.uk
www.ductube.co.uk

BRC Special Products Technical Advice Service

Our in-house technical team provides a comprehensive technical advice service for the complete range of products.

Services include:

- Free design service
- Telephone enquiry service
- Office/on-site support and advice
- Details and take-offs

Sales support

All products are supported by a national team of sales people who are always available to discuss a particular application or project and provide on-site support as required.

Our product range includes:

Brickforce® - structural masonry reinforcement
Rendalath® - reinforced render carrier system
Pecafil® - permanent formwork system
Stremaform® - permanent formwork material
Pudlo® - concrete waterproofing admixture
Shearail® - punching shear reinforcement system
Deltabeam® - composite beam system
Ductube® - tubular void former
Precast concrete accessories

