

ELECTRIC VIBRATORS FOR INDUSTRIAL USE - MVSI S90

8 POLES - 750/900 RPM

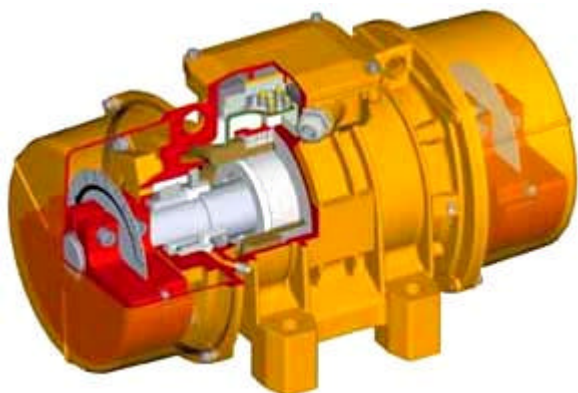

DIMENSIONAL SPECIFICATIONS (mm)

TYPE	SIZE	CSA	Static moment kgmm		Centrifugal force				Weight		Max. input power W		Max. current A		Ia/In	
			50Hz	60Hz	kg		kN		kg		50Hz	60Hz	50Hz	60Hz	50Hz	60Hz
					50Hz	60Hz	50Hz	60Hz	50Hz	60Hz						
MVSI 075/150-S90	20	°	163	163	104	149	1.02	1.46	16.9	16.9	230	250	0.85	0.76	2.13	2.11
MVSI 075/250-S90	30	°	286	286	181	260	1.76	2.55	23.5	23.5	350	380	1.1	1.05	2.03	2.29
MVSI 075/400-S90	35	°	457	457	288	415	2.83	4.07	36.5	36.5	280	300	0.6	0.58	1.73	2.5
MVSI 075/660-S90	40	°	723	723	456	656	4.47	6.44	54	54	400	450	1.2	1.2	2.38	2.58
MVSI 075/910-S90	50	°	1012	1012	637	917	6.25	9	67	67	400	500	1.4	1.3	2.38	2.85
MVSI 075/1310-S90	60	°	1464	1464	922	1327	9.04	13	94	94	950	1100	2.2	2.2	2.63	3.41
MVSI 075/2110-S90	70	°	2326	2326	1463	2107	14.4	20.7	130	130	1500	1790	4.1	4.2	3.55	2.95
MVSI 075/3110-S90	80	°	3421	3421	2152	3099	21.1	30.4	188	188	2000	2300	5.4	5.2	3.98	4.62
MVSI 075/3800-S90	80	-	4206	4206	2645	3808	25.9	37.4	204	204	2500	3000	6	6	4	4.2
MVSI 075/4200-S90	90	°	4658	4658	2930	4218	28.7	41.4	238	238	2800	3350	6.5	6.5	3.84	4
MVSI 075/5300-S90	90	°	5838	5838	3672	5287	36	51.9	268	268	4000	4300	8.2	7.85	3.87	5.35
MVSI 075/6500-S90	95	-	7197	7197	4526	6517	44.4	63.9	320	320	4900	5800	9.9	9.5	3.04	3.26
MVSI 075/10000-S90	97	-	12390	10973	7792	9937	76.4	97.5	438	419	6800	7450	13.2	12	3.33	3.92
MVSI 075/12000-S90	100	-	13816	12407	8689	11235	85.2	110	540	520	7600	8300	14	13.5	3.72	3.78
MVSI 075/14000-S90	105	-	17946	15500	11285	14036	111	138	702	680	9200	9600	21	19.5	4.99	5.44
MVSI 075/17000-S90	105	-	21337	19064	13418	17263	132	169	755	711	10400	11140	22	20	5.5	5.9
MVSI 075/22000-S90	110	-	28633	24508	18005	22192	177	218	1015	981	12500	16200	26.5	28	5.63	4.71

ELECTRIC VIBRATORS FOR INDUSTRIAL USE - MVSI S90

8 POLES - 750/900 RPM

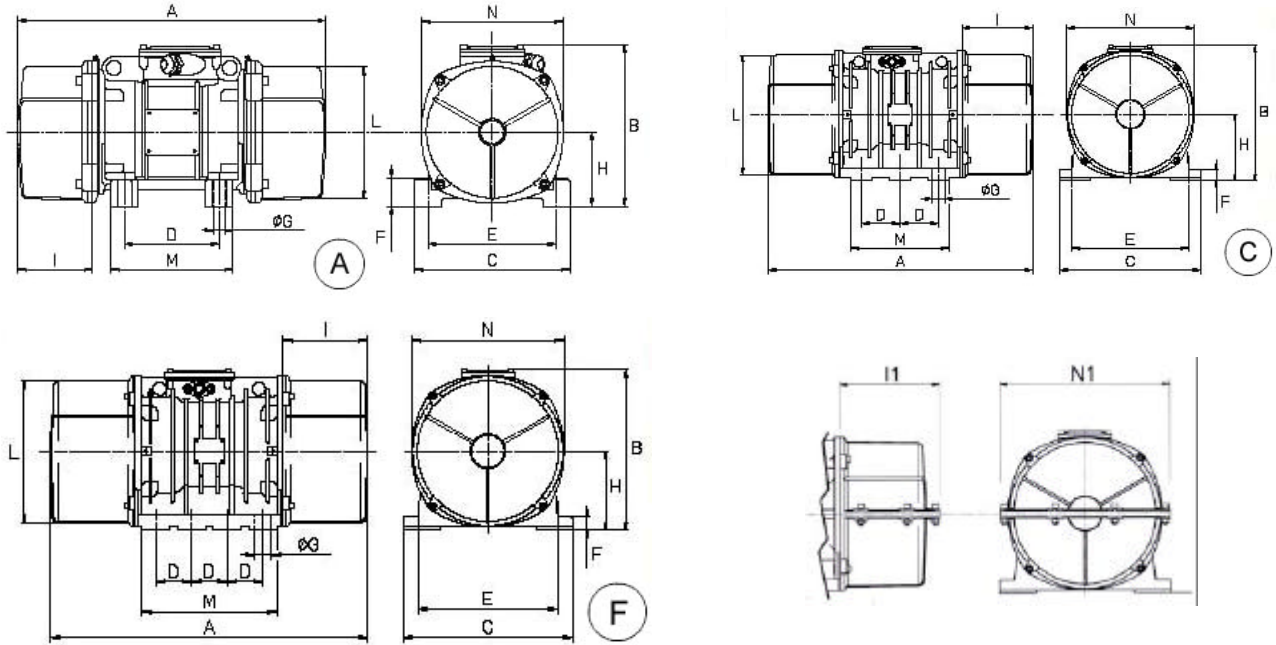

Type	Figure	A	B	C	D	E	ØG	N°	F	H	I	L	M	N	Versions with 1 or 2 split covers		Cable entry thread
															I1	N1	
MVSI 075/150-S90	A	345	198	167	105	140	13	4	28.5	80	90	146	137	153	-	-	PG16
MVSI 075/250-S90	A	381	210	205	120	170	17	4	45	91.5	88	168	160	178	-	-	PG16
MVSI 075/400-S90	A	435	233	205	120	170	17	4	54	104.5	117.5	187	162	203	-	-	PG16
MVSI 075/660-S90	A	500	246	230	140	190	17	4	54	116	134	210	180	225	-	-	PG16
MVSI 075/910-S90	A	568	246	230	140	190	17	4	54	116	168	210	180	225	-	-	PG16
MVSI 075/1310-S90	A	617	273	278	155	225	22	4	72	133	177	238	205	253	-	-	PG16
MVSI 075/2110-S90	A	666	333	310	155	255	23.5	4	77	157	178	280	215	295	-	-	PG21
MVSI 075/3110-S90	A	734	360	340	180	280	26	4	80	165	202	305	240	320	226	356	PG21
MVSI 075/3800-S90	A	796	360	340	180	280	26	4	80	165	233	305	240	320	-	-	PG21
MVSI 075/4200-S90	A	740	370	390	200	320	28	4	90	180	190	330	270	350	266	382	PG21
MVSI 075/5300-S90	A	840	370	390	200	320	28	4	90	180	240	330	270	350	266	382	PG21
MVSI 075/6500-S90	A	870	395	392	200	320	28	4	100	192	255	355	270	375	280	410	PG21
MVSI 075/10000-S90	C	1002	436	460	125	380	38	6	35	215	300	387	320	414	-	-	1 inch GAS°
MVSI 075/12000-S90	C	1070	454	530	140	440	45	6	38	230	280	423	370	448	-	-	1 inch GAS°
MVSI 075/14000-S90	F	1040	526	570	140	480	45	8	41	268	240	485	510	516	270	566	1 inch GAS°
MVSI 075/17000-S90	F	1120	526	570	140	480	45	8	41	268	280	485	510	516	310	566	1 inch GAS°
MVSI 075/22000-S90	F	1150	607	610	140	520	45	8	38	297	297.5	542	510	582	-	-	1 inch GAS°