

# ELECTRIC VIBRATORS FOR INDUSTRIAL USE - MVSI S90

## 2 POLES - 3000/3600 RPM

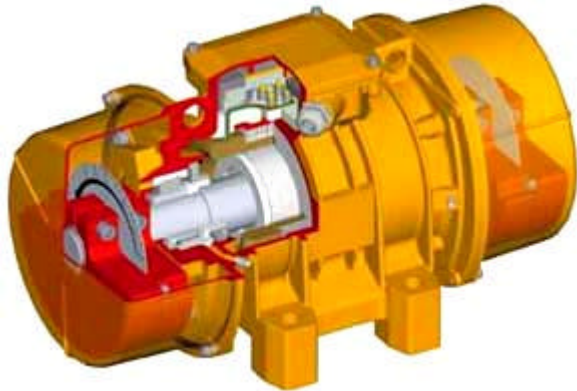

### DIMENSIONAL SPECIFICATIONS (mm)

TYPE	SIZE	CSA	Static moment kgmm		Centrifugal force Kg N				Weight kg		Max. input power W		Max. current A		Ia/In	
			50Hz	60Hz	50Hz	60Hz	50Hz	60Hz	50Hz	60Hz	50Hz	60Hz	50Hz 380V	60Hz 460V	50Hz	60Hz
MVSI 3/100-S90	00	°	9.82	6.54	100	96	0.981	0.942	4.3	4.1	180	180	0.35	0.3	2.68	3
MVSI 3/200-S90	01	°	19.1	12.1	193	177	1.89	1.74	5	4.6	180	180	0.35	0.3	2.68	3
MVSI 3/300-S90	10	°	30.1	20.4	304	297	2.98	2.91	8.3	7.8	260	270	0.6	0.5	3.47	4.2
MVSI 3/500-S90	20	°	49.9	32.4	503	471	4.93	4.62	12.5	11.6	450	500	0.8	0.75	4.21	4.8
MVSI 3/800-S90	30	°	78	52	785	754	7.7	7.4	16.8	15.9	650	685	1.1	1	3.83	6
MVSI 3/1100-S90	35	°	110	73	1105	1061	10.8	10.4	23	22	1000	1200	1.75	1.75	3.63	4
MVSI 3/1310-S90	AF33	°	128	91.6	1290	1327	12.7	13	31	29.7	1300	1350	2.1	1.9	3.96	4.98
MVSI 3/1510-S90	AF50	°	153	102	1545	1483	15.2	14.5	39.5	38	1400	1450	2.3	2	4.95	6.12
MVSI 3/1810-S90	AF50	°	179	128	1802	1853	17.7	18.2	40.5	39	2000	2000	3.3	2.9	4.33	5.5
MVSI 3/2010-S90	AF50	°	205	128	2059	1853	20.2	18.2	48.7	46.3	2200	2200	3.5	3	4.62	6
MVSI 3/2310-S90	AF50	°	230	153	2316	2224	22.7	21.8	49.6	47.1	2200	2200	3.5	3	4.62	6
MVSI 3/3200-S90	AF70	°	344	215	3457	3112	33.9	30.5	94	90	4000	4000	6.5	5.6	4.46	5.18
MVSI 3/4000-S90	AF70	°	387	258	3890	3735	38.2	36.6	96	92	4000	4000	6.5	5.6	4.46	5.18
MVSI 3/5000-S90	AF70	°	515	344	5187	4979	50.9	48.8	109	105	5000	5000	7.6	6.9	5.54	7.1
MVSI 3/6510-S90	90	-	630	443	6357	6420	62.4	63	184	178	5500	5500	9.2	8	6.45	7.2
MVSI 3/9000-S90	95	-	895	619	9007	8970	88.4	88	215	210	10000	9300	18	13	4.39	5.23

### SINGLE-PHASED VERSIONS

TYPE	SIZE	CSA	Static moment kgmm		Centrifugal force Kg N				Weight kg		Max power W		Max current A		Ia/In	
			50Hz	60Hz	50Hz	60Hz	50Hz	60Hz	50Hz	60Hz	50Hz	60Hz	220V	115V	50Hz	60Hz
MVSI 3/100-S90	00	°	9.82	6.54	100	96	0.981	0.942	4.3	4.1	165	165	0.75	1.52	1.67	2.24
MVSI 3/200-S90	01	°	19.1	12.1	193	177	1.89	1.74	5	4.6	165	165	0.75	1.52	1.67	2.24
MVSI 3/300-S90	10	°	30.1	20.4	304	297	2.98	2.91	8.3	7.8	280	280	1.25	2.4	2.48	3.52
MVSI 3/500-S90	20	°	49.9	32.4	503	471	4.93	4.62	12.5	11.6	500	500	2.3	4.5	3.35	4.22
MVSI 3/800-S90	30	°	78	52	785	754	7.7	7.4	16.8	15.9	700	750	3.25	7	4	4.14

## ELECTRIC VIBRATORS FOR INDUSTRIAL USE - MVSII S90

### 2 POLES - 3000/3600 RPM

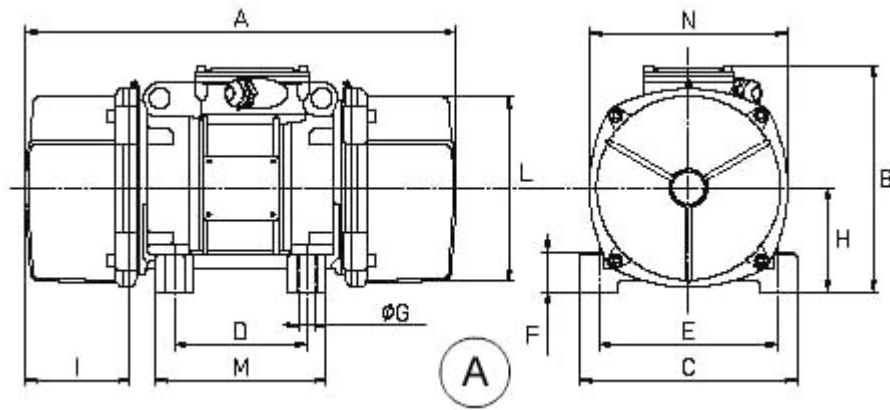

Type	Figure	A	B	C	D	E	ØG	Nº	F	H	I	L	M	N	Cable entry thread
MVSI 3/100-S90	A	210	142	125	62-74	106	9	4	15	55	40	90	102	102	PG13.5
MVSI 3/200-S90	A	220	151	125	62-74	106	9	4	24	64	45	112	102	119	PG13.5
MVSI 3/300-S90	A	245	182	152	90	125	13	4	29.5	73	47	127	117	135	PG13,5
MVSI 3/500-S90	A	277	199	167	105	140	13	4	28.5	80	55.5	146	137	153	PG16
MVSI 3/800-S90	A	307	210	205	120	170	17	4	45	91.5	51	168	160	178	PG16
MVSI 3/1100-S90	A	372	233	205	120	170	17	4	54	104.5	86	187	162	203	PG16
MVSI 3/1310-S90	A	355	213.5	215	100	180	17	4	47	92.5	81.5	164	140	179	PG16
MVSI 3/1510-S90	A	430	230	230	140	190	17	4	49	104	87.5	186	180	200	PG16
MVSI 3/1810-S90	A	430	230	230	140	190	17	4	49	104	87.5	186	180	200	PG16
MVSI 3/2010-S90	A	465	230	230	140	190	17	4	49	104	105	186	180	200	PG16
MVSI 3/2310-S90	A	465	230	230	140	190	17	4	49	104	105	186	180	200	PG16
MVSI 3/3200-S90	A	558	304	310	155	255	25	4	90	130	108	233	210	248	PG21
MVSI 3/4000-S90	A	558	304	310	155	255	25	4	90	130	108	233	210	248	PG21
MVSI 3/5000-S90	A	558	304	310	155	255	25	4	90	130	108	233	210	248	PG21
MVSI 3/6510-S90	A	676	370	390	200	320	28	4	90	180	158	330	270	350	PG21
MVSI 3/9000-S90	A	629	395	392	200	320	28	4	100	192	135	355	270	375	PG21